

H55D S, H65D S

Hydraulic Hammers for Skid Steer and Multi Terrain Loaders



Features

High Oil Flow Acceptance

Less Parts

6-Piece Isolation System

Silenced as Standard

Benefits

The hammer has a high frequency and high productivity to get the job done fast. Due to the wide oil flow acceptance range, the hammer can be used across a wide range of carrier brands for maximum utilization within a mixed carrier fleet.

Owning and operating costs are minimized. Wear parts are field replaceable without the need for special tools thus minimizing downtime and increasing up time and productivity.

Isolates vibration transmitted to the carrier via stick and boom for machine protection and operator comfort.

For operation in residential and noise-sensitive applications where compliance with regulations must be met.

CATERPILLAR®

Hydraulic Hammers for SSL and MTL

- 1 Integral Mounting Arrangement** – Easily adaptable to mounting on Skid Steer Loader and Multi Terrain Loaders.
- 2 2-Position Hose Mounting** – optimized hose routing for each installation, protecting hoses from damage and wear.
- 3 One Piece Body** – reduced hammer components minimize service time required.
- 4 Inlet (HP) Surge Accumulator** – protects host machine from hydraulic pulsations, improving hydraulic component life.
- 5 Low Pressure Tubular Accumulator**– assists in the power stroke of the piston.
- 6 Distributor** – high oil volume for greater blow frequency.
- 7 Pressure Adjusting Valve (PAV)** – assures that all blows are delivered at a constant blow energy.
- 8 Piston** – long heavy piston delivers maximum impact energy and minimizes recoil forces to carrier.
- 9 Replaceable Piston Sleeve** – reduces the cost to repair in event of catastrophic failure, simplifies serviceability.
- 10 6-Piece Isolation System** – significantly reduces shock loads transferred to the machine during hammer operation, to improve operator comfort and extend life of critical machine components.
- 11 Round Tool Retaining Pin with Locking Mechanism** – no loose parts when changing tool.
- 12 Single Piece Upper & Lower Tool Bushing with Integral Tool Stop** – simplifies product maintenance by allowing field replacement of all tool wear components.
- 13 Dust Seal** – helps prevent foreign material from entering the housing, which reduces the wear on the power cell and other major components.
- 14 Tool** – heat treated for longer life, ideally matched to piston for greater transfer of energy.
- 15 Enclosed Housing** – provides protection to the power cell and provides noise reduction.

H55D S, H65D S



Applications Guide with Standard Tools



Chisel

Applications

- Sedimentary and weak metamorphic rock into which tool penetrates
- Concrete

C

Select when:

- Working in non-abrasive but ductile rock
- Needing medium penetration rate into rock



Moil

Applications

- Sedimentary and weak metamorphic rock into which tool penetrates
- Concrete

M

Select when:

- Working in soft, non-abrasive rock
- Needing greater protection against excessive retaining pin groove wear



Spade (parallel or transverse)

Applications

- Frozen or compact ground
- Asphalt

S

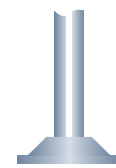

Compacting Plate

Applications

- Ground compacting

CP

- C Chisel
- M Moil
- S Spade
- CP Compacting Plate

Roadbuilding/construction

	H55Ds	H65Ds
Breaking of road surface	C, M, S	C, M, S
Asphalt cutting to shape or area	C, S	C, S
Demolition of bridges	C, M	C, M
Compacting soils	CP	CP
Making holes (for traffic signs, lamp posts)	M	M
Breaking of frozen ground	C, M, S	C, M, S

Demolition/housing development

Demolition of concrete walls, roofs, floors	C, M	C, M
Demolition of light, reinforced concrete foundation	M	M
Brick walls	C, M	C, M
Separating rebar from concrete (for recycling)	C, M	C, M

Metallurgical applications

Breaking of refractory linings in furnaces	C, M	C, M
--	------	------

Specifications

		H55D S	H65D S
Recommended carrier weight	tonnes	2.5-4.5	3.0-6.5
Working weight*	kg	199	271
Impact frequency	bpm	1022-2300	700-2000
Acceptable oil flow	liter/min	40-85	40-105
Operating pressure	bar	170	170

* Working weight includes hammer, standard tool and average mounting bracket.



H55D S, H65D S Hammers

Dimensions

		H55D S	H65D S
A	mm	429	454
B	mm	300	300
C	mm	997	1055
D	mm	56	65
E	mm	299	330

H55D S & H65D S

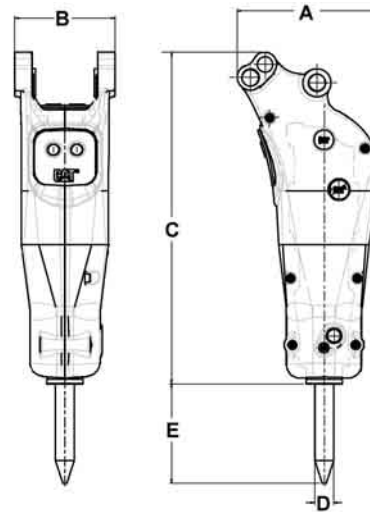

Hydraulic Requirements

Auxiliary hydraulic as standard in machine.

Matching Guide

Hammer	Skid Steer Loaders*	Multi Terrain Loaders
H55D S	216B, 226B, 232B, 236B, 242B, 246B, 248B, 252B, 262B, 268B	247B, 257B, 267B, 277B, 287B
H65D S	216B, 226B, 232B, 236B, 242B, 246B, 248B, 252B, 262B, 268B	247B, 257B, 267B, 277B, 287B

* SSL with BH150 or BH160 match hammers to SSL as per above.